

We'll take you to the top

LADDERS



Easy

Fast

Safe



ČERVINKA s.r.o.
NAŠE SLUŽBY – VAŠE BEZPEČNOST



ČERVINKA
CZECH REPUBLIC S.R.O.



Official distributor for Czech republic

130 years of experience



ČERVINKA s.r.o.
NAŠE SLUŽBY – VAŠE BEZPEČNOST

ČERVINKA
CZECH REPUBLIC S.R.O.



Official distributor for Czech republic



130 years of experience



Illustrative pictures

A natural product

- made from hand-selected pine wood
- built with hardwood standing rungs
- robust, galvanized fittings, screws and self-locking nuts
- option of galvanized chain or nylon opening restraint
- weather resistant
- load capacity of up to 150kg

Type 12

Timber step ladder

A universal ladder for professional and everyday use

- tested and manufactured according to ÖNORM EN 131 and ÖNORM Z 1501 standards
- distance between rungs is 30cm
- distance between the top non-mountable rungs is 32 cm, which allows for comfortable standing
- models 12-013 and 12-014 use multiple laminated beams

Model No.	Ladder length	Weight approx.
12-003	1,06 m	5 kg
12-004	1,36 m	6 kg
12-005	1,66 m	7 kg
12-006	1,96 m	8,5 kg
12-007	2,26 m	9,5 kg
12-008	2,56 m	12,5 kg
12-009	2,86 m	13 kg
12-010	3,16 m	16 kg
12-011	3,46 m	18 kg
12-012	3,76 m	19 kg
12-013 *	4,06 m	26,5 kg
12-014 *	4,36 m	30 kg

* only available by order



12-006
Timber step ladder

Anti-slip safety feet

- easy to attach
- plastic material leaves no scratches or scuff-marks on floor surfaces
- extends the life of the ladder

Model No.	Suitable for ladder Model No.
FIS-1008	12-003 nebo 12-008 (60 mm beam size)
FIS-1009	12-009 (65 mm beam size)
FIS-1021	12-010 až 12-014 (screwable, for all larger beam sizes)

Ladder leveler

- allows for ladder use on stairs or uneven ground
- uses dual clamps for easy attachment without the use of tools

Model No.	Suitable for ladder Model No.
19-021	12-003 až 12-009 (65 mm beam size)
19-023	12-010 až 12-014 (over 65 mm beam size)



19-023
Ladder leveler



FIS-1021
Anti-slip safety feet (screwable)



FIS-1008 / FIS-1009
Anti-slip safety feet

Timber leaning ladders

Type 31

Timber leaning ladder with rungs

- tested and manufactured according to ÖNORM EN 131 standards
- hardwood standing rungs
- double wedge connections between rungs and beams
- weather resistant
- total ladder width of approx. 39 cm

Model No.	Ladder length	Weight approx.
31-006	1,9 m	4 kg
31-008	2,5 m	6 kg
31-009	2,8 m	6,5 kg
31-011	3,4 m	8 kg
31-013 *	4 m	9,5 kg

*Only available by order

Type 36

Timber leaning ladder with treads

- tested and manufactured according to ÖNORM EN 131 standards
- comfortable and safe to climb
- 80 mm deep, treads
- 4 bolts connect the rungs to the side beams
- additional safety beam under every second step
- total ladder width of approx. 40cm

Model No.	Ladder length	Weight approx.
36-006 *	1,64 m	4,5 kg
36-007 *	1,88 m	5 kg
36-008 *	2,11 m	5,5 kg
36-009 *	2,35 m	6 kg
36-010 *	2,58 m	7 kg
36-011 *	2,82 m	8,5 kg
36-012 *	3,05 m	9,5 kg
36-013 *	3,29 m	10,5 kg
36-014 *	3,52 m	11,5 kg

*Only available by order

Note:

To comply with the new EN 131-1 safety standards, one of the following options is required for ladders 31-011 and 36-012:

- stabiliser Bar (see below)
- safting Hooks (see Accessories on page 20)

Stabiliser bar for timber ladder

- plastic feet are slip-resistant and protect floor surfaces from scratches and scuff-marks
- easy to attach

Model No.	Details
19-163	Stabiliser bar
19-163M	Stabiliser bar - preassembled



19-163
Stabiliser bar

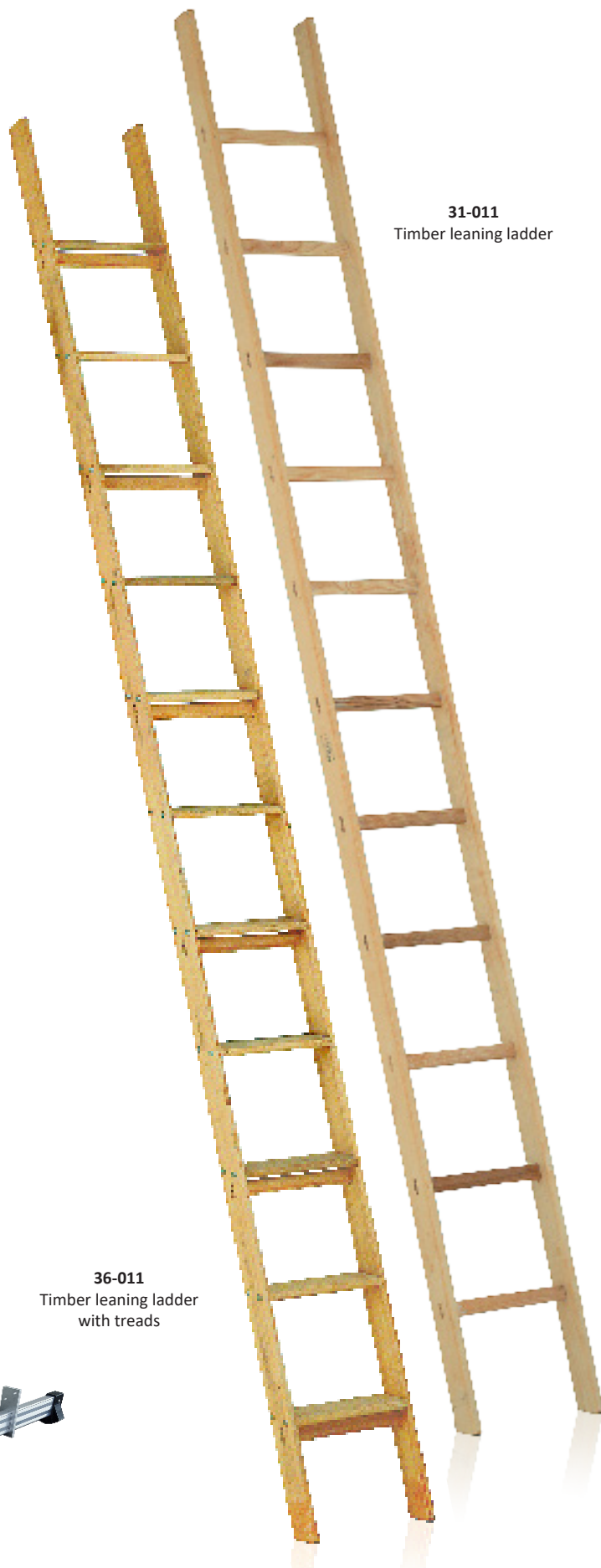

31-011
Timber leaning ladder

36-011
Timber leaning ladder
with treads

Robust leaning and step ladders

Robust aluminium ladders

- optimal price/performance ratio
- built with anti-slip rungs which are CMT welded into specially designed double-walled, hollow-profile beams
- includes plastic anti-slip safety feet and top end-caps to ensure firm positioning during use
- maximum weight capacity of 150 kg (to comply with ÖNORM EN 131 standards)
- distance between rungs is 28 cm



R-308
Robust-step ladder

Type R-100 Aluminium leaning ladder

- tested and manufactured according to ÖNORM EN 131 standards
- plastic anti-slip safety feet and top end-caps ensure firm positioning during use
- total ladder width of approx. 36 cm
- models R-112 to R-118 include a Stabiliser bar

Model No.	Ladder length	Weight approx.	Stabiliser bar size
R-106	1,96 m	3 kg	-
R-108	2,52 m	4,5 kg	-
R-110	3 m	5,6 kg	-
R-112	3,64 m	6,7 kg	0,8 m
R-114	4,2 m	7,8 kg	0,8 m
R-116	4,76 m	8,9 kg	1 m
R-118	5,32m	10 kg	1 m

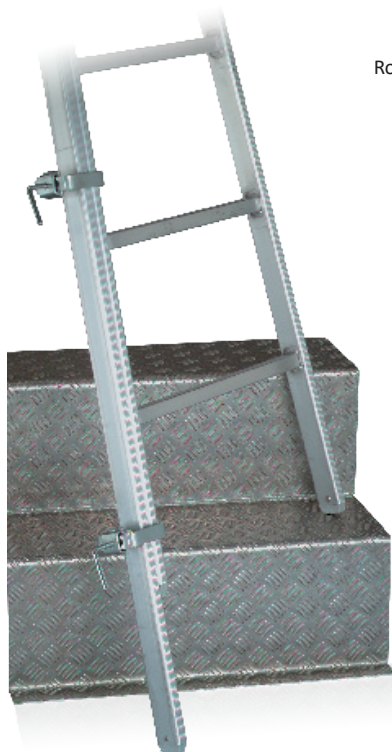

R-112
Robust leaning ladder

Type R-300 Aluminium step ladder

- tested and manufactured according to ÖNORM EN 131 standards
- built with tear-resistant nylon opening restraint
- optional galvanized opening restraint instead of nylon (only available by order)

Model No.	Ladder length	Weight approx.
R-304	1,36 m	6 kg
R-305	1,64 m	7 kg
R-306	1,92 m	7,2 kg
R-307	2,2 m	9 kg
R-308	2,48 m	9,7 kg
R-309	2,76 m	11,5 kg
R-310	3,04 m	12,2 kg
R-312	3,6 m	15 kg

Ladder leveler

- allows for ladder use on stairs or uneven ground
- uses dual clamps for easy attachment without the use of tools

Model no.	Lenght	Suitable for ladder Model No.
19-520	60 mm	R-300 stejně jako 52-009 až 52-018

19-520
Ladder leveler



Robust extension ladder

Type R-200

Aluminium extension ladder

2 - part

- tested and manufactured according to ÖNORM EN 131 standards
- plastic-coated steel rung hooks and locking tabs secure sections together during use (see image)
- built with heavy-duty guide brackets
- total ladder width of approx. 42cm

Model No.	Ladder length		Weight approx.	Stabiliser bar size
	Closed	Extended		
R-206	1,97 m	3,16 m	7,5 kg	0,8 m
R-208	2,53 m	4,28 m	10 kg	0,8 m
R-210	3,09 m	5,4 m	12 kg	1 m
R-212	3,65 m	6,22 m	15 kg	1 m
R-214	4,21 m	7,3 m	18 kg	1,2 m

Type R-600

Aluminium extension ladder

2 - part, rope operated

- tested and manufactured according to ÖNORM EN 131 standards
- fully automated plastic-coated steel rung hooks secure sections together during use (see image)
- built with heavy-duty guide brackets
- includes rope and wall-running wheels for smooth and easy extension (see image)
- total ladder width of approx. 42 cm

Model No.	Ladder length		Weight approx.	Stabiliser bar size
	Closed	Extended		
R-614	4,23 m	7,3 m	18 kg	1,2 m
R-616	4,79 m	8,14 m	21kg	1,2 m
R-618	5,35 m	9,3 m	26 kg	1,2 m
R-620	5,93 m	10,1 m	30 kg	1,2 m

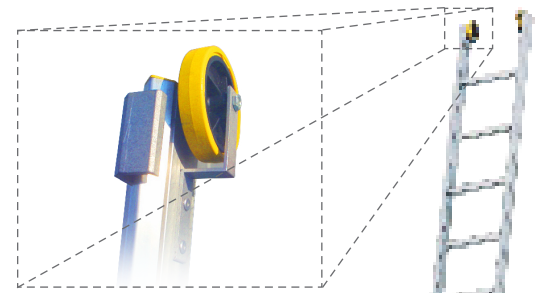

Wall-running wheels



Rope and pulley extension system

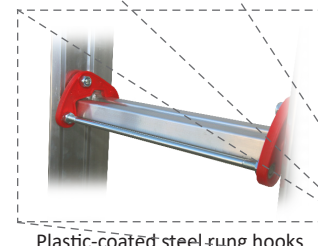

Plastic-coated steel rung hooks

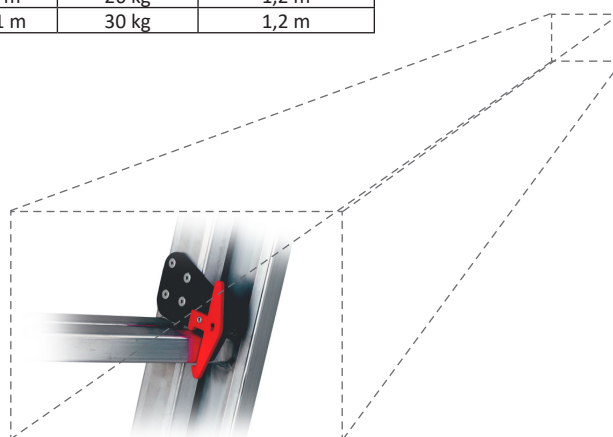

Plastic coated steel rung hooks

R-212
Robust extension ladder

R-616
Robust extension ladder

Robust combination ladders



R-509
Combination ladder
Length B



RF-510
Combination ladder
Length B



R-508
Combination ladder
Length C



RF-509
Combination ladder
Length C

Type R-500

Aluminium combination ladder

3 - part

- tested and manufactured according to ÖNORM EN 131 standards
- multifunctional; can be used as a step ladder, free-standing ladder, as well as a double and triple section extension ladder
- plastic-coated steel rung hooks and locking tabs secure sections together during use
- built with heavy duty guide brackets
- tapered base creates stability for safe climbing
- includes galvanized chain opening restraint

Model No.	Length			Weight approx.
	A	B	C	
R-506	1,81 m	3,05 m	3,91 m	12,5 kg
R-507	2,09 m	3,61 m	4,75 m	14 kg
R-508	2,37 m	4,17 m	5,87 m	15,5 kg
R-509	2,65 m	4,45 m	6,14 m	17 kg
R-510	2,93 m	5,29 m	7,27 m	21 kg
R-512	3,49 m	6,13 m	8,69 m	26 kg

A... Step ladder
B... Free-standing ladder
C... Triple section extension ladder

Type RF-500

Aluminium combination ladder

3 - part

- tested and manufactured according to ÖNORM EN 131 standards
- RF-500 model ladders include the same features as the R-500 models, with the exception of a Stabiliser bar to secure the ladder rather than a tapered base

Model No.	Length			Weight approx.	Stabiliser bar size
	A	B	C		
R-506	1,81 m	3,05 m	3,91 m	12,5 kg	0,8 m
R-507	2,09 m	3,61 m	4,75 m	14 kg	0,8 m
R-508	2,37 m	4,17 m	5,87 m	15,5 kg	0,8 m
R-509	2,65 m	4,45 m	6,14 m	17 kg	0,8 m
R-510	2,93 m	5,29 m	7,27 m	21 kg	1 m
R-512	3,49 m	6,13 m	8,69 m	26 kg	1 m

A... Step ladder
B... Free-standing ladder
C... Triple section extension ladder

Industrial combination ladders

Industrial aluminium ladders

- for heavy-duty industrial and commercial use
- built with anti-slip rungs which are CMT welded into specially designed double-walled, hollow-profile beams
- includes plastic anti-slip safety feet and top end-caps to ensure firm positioning during use
- maximum weight capacity of 150kg (to comply with ÖNORM EN 131 standards)
- distance between rungs is 28 cm

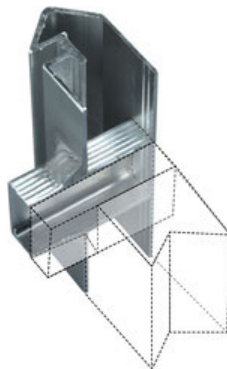

Type 53

Aluminium combination ladder

3 - part

- tested and manufactured according to ÖNORM EN 131 standards
- multifunctional; can be used as a step ladder, free-standing ladder, as well as a double and triple section extension ladder
- built with heavy-duty guide brackets
- stabiliser bar used for firm positioning while in use (see image)
- includes galvanized chain opening restraint

Model No.	Length			Weight approx.	Stabiliser bar size
	A	B	C		
53-006 ○	2,07 m	2,85 m	4,49 m	14 kg	0,8 m
53-007 ○	2,33 m	3,37 m	5,03 m	16 kg	0,8 m
53-008 ○	2,51 m	3,82 m	5,62 m	18 kg	1 m
53-009 ○	2,82 m	4,1 m	6,17 m	19 kg	1 m
53-010 ●	3,16 m	4,77 m	7,02 m	25 kg	1 m
53-012 ●	3,68 m	5,78 m	8,42 m	29 kg	1,2 m
53-014 ●	4,22 m	6,86 m	10,4 m	32 kg	1,2 m

○ ... includes plastic-coated semi-automated steel rung hooks on the upper section and plastic-coated steel rung hooks on the lower section

● ... includes plastic-coated semi-automatic rung hooks on both upper and lower sections, as well as wall-running wheels for smooth and easy extension

A... Step ladder

B... Free-standing ladder

C... Triple section extension ladder

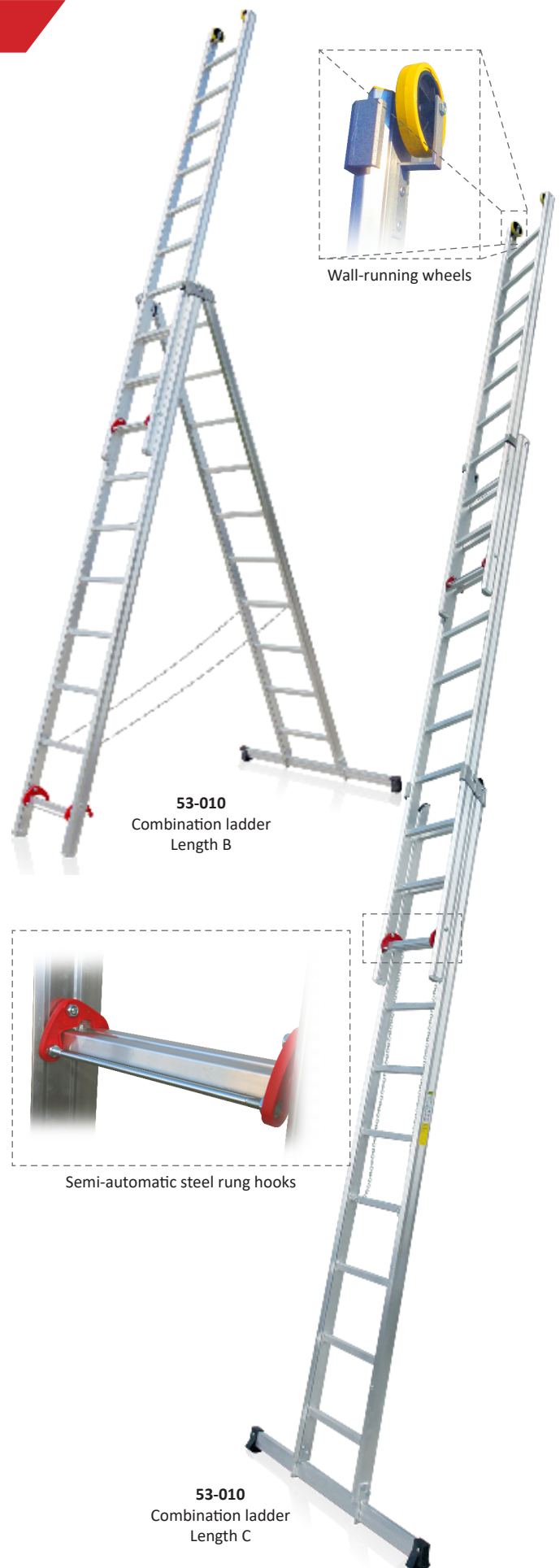

Industrial leaning & extension ladders

Type 50

Aluminium leaning ladder with rungs

- tested and manufactured according to ÖNORM EN 131 standards
- includes plastic anti-slip safety feet and top end-caps to ensure firm positioning during use
- distance between rungs is 28 cm
- total ladder width of approx. 36 cm
- models 50-011 to 50-026 are built with a Stabiliser bar

Model No.	Length	Weight approx.	Stabiliser bar size
50-006	1,95 m	3,5 kg	-
50-007	2,23 m	4 kg	-
50-008	2,51 m	4,5 kg	-
50-009	2,79 m	5 kg	-
50-010	3 m	5,5 kg	-
50-011	3,35 m	6,1 kg	0,8 m
50-012	3,61 m	8 kg	0,8 m
50-013	3,89 m	8,7 kg	0,8 m
50-014	4,17 m	9,3 kg	0,8 m
50-015	4,45 m	9,9 kg	1 m
50-016	4,73 m	10,5 kg	1 m
50-018	5,29 m	11,8 kg	1 m
50-020	5,85 m	13,1 kg	1 m
50-022	6,48 m	15,6 kg	1,2 m
50-024	7,04 m	17 kg	1,2 m
50-026	7,6 m	18,6 kg	1,2 m

Type 51

Aluminium extension ladder 2 - part

- tested and manufactured according to ÖNORM EN 131 standards
- plastic-coated steel rung hooks and locking tabs secure sections together during use (see image)
- built with heavy-duty guide brackets
- total ladder width of approx. 43cm

Model No.	Length		Weight approx.	Stabiliser bar size
	Closed	Extended		
51-006	1,97 m	3,12 m	8 kg	0,8 m
51-008	2,53 m	4,24 m	11 kg	1 m
51-010	3,09 m	5,36 m	13 kg	1 m
51-012	3,65 m	6,21 m	15 kg	1,2 m
51-014	4,23 m	7,34 m	20 kg	1,2 m
51-016	4,79 m	8,11 m	25 kg	1,2 m
51-018	5,35 m	9,24 m	29 kg	1,2 m

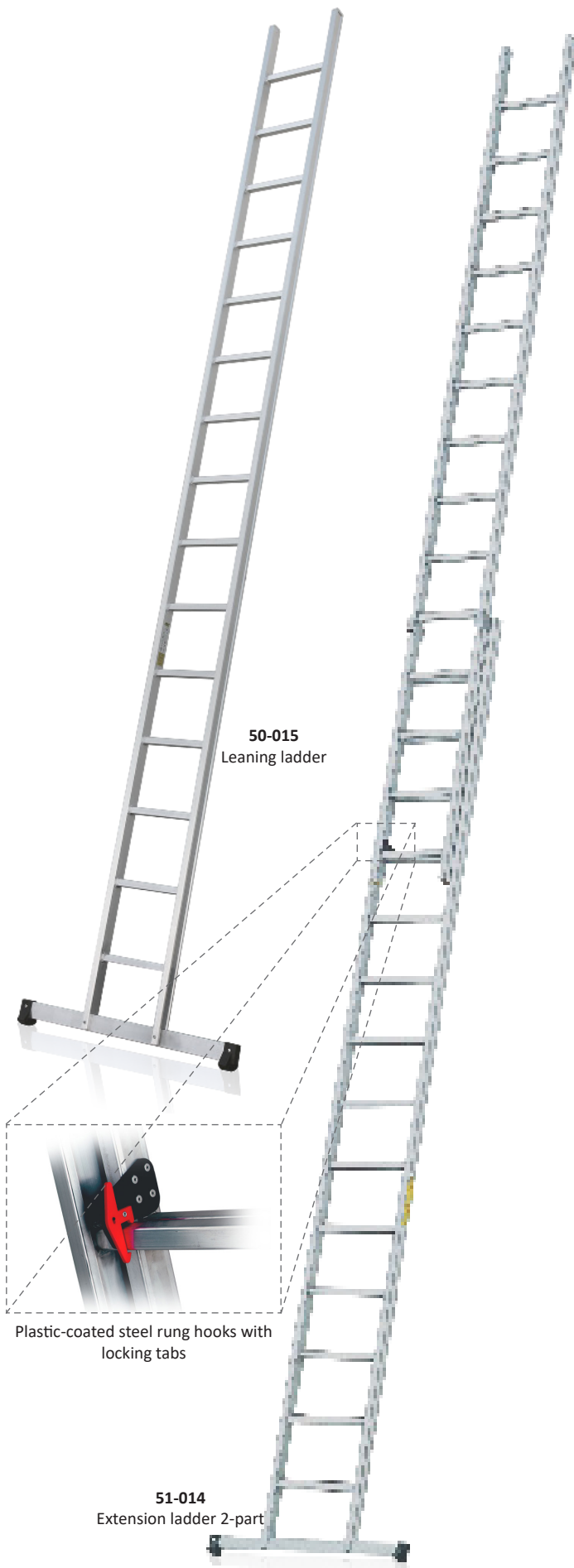

Industrial extension ladders

Type 56

Aluminium extension ladder

2 - part, rope operated

- tested and manufactured according to ÖNORM EN 131 standards
- fully-automated plastic-coated steel rung hooks secure sections together during use (see image)
- built with heavy-duty guide brackets on both upper and lower sections
- includes rope and wall-running wheels for smooth and easy extension (see image)
- total ladder width of approx. 43 cm

Model No.	Length		Weight approx.	Stabiliser bar size
	Closed	Extended		
56-010	3,1 m	5,2 m	17 kg	1 m
56-012	3,67 m	6,22 m	18 kg	1 m
56-014	4,23 m	7,34 m	21 kg	1,2 m
56-016	4,79 m	8,11 m	26 kg	1,2 m
56-018	5,35 m	9,24 m	30 kg	1,2 m
56-020	5,91 m	9,84 m	35 kg	1,2 m
56-022 ^	6,47 m	11,21 m	38 kg	-
56-024 ^*	7,03 m	12,12 m	41 kg	-
56-026 ^*	7,59 m	13,23 m	44 kg	-
56-028 ^*	8,15 m	14,35 m	48 kg	-

*Only available by order

Note:

In order to comply with safety standards, additional safety Stabilisers are required for models marked with ^. The appropriate Stabiliser for each of these ladders can be found in the table below.

Stabilisers

for type 56

Model No.	Suitable for ladder Model No.	Weight approx.
56-001	56-022	3,9 kg
56-002	56-024	4,8 kg
56-003	56-026	5,1 kg
56-004	56-028	5,1 kg

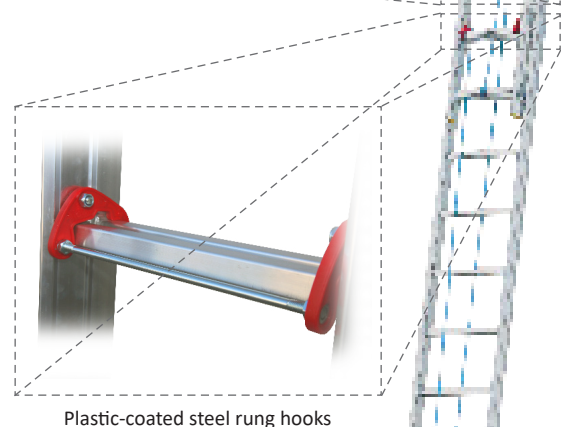
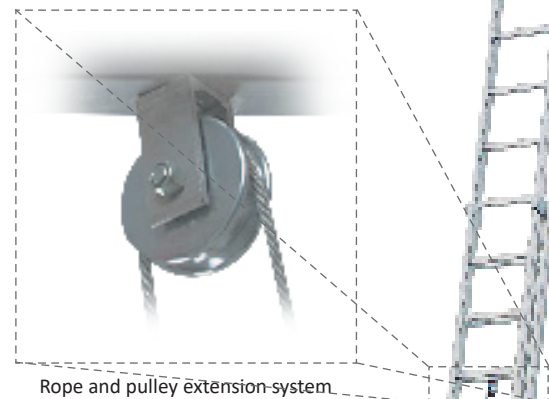
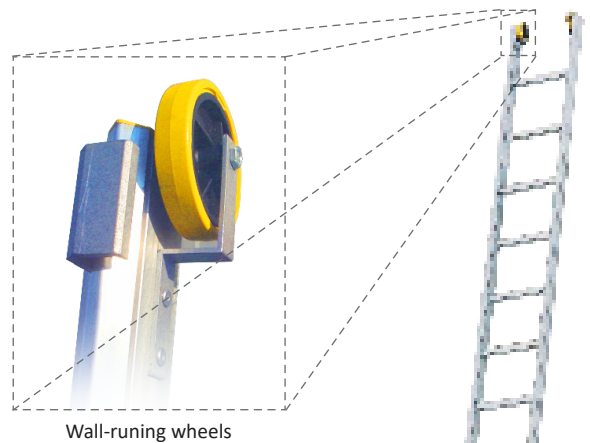

56-018
Extension ladder
2-part, rope operated

Industrial extension ladders

Type 57

Aluminium extension ladder

3 - part, rope operated

- tested and manufactured according to ÖNORM EN 131 standards
- built with automatic aluminium rung safety lock (see image)
- equipped with two parallel running rope operated extension systems. The lower pulley system uses a non-slip plastic rope, while the upper pulley system uses a galvanized steel rope (see images)
- heavy-duty guide brackets and wall-running wheels allow for smooth and easy extension
- total ladder width of approx. 50 cm

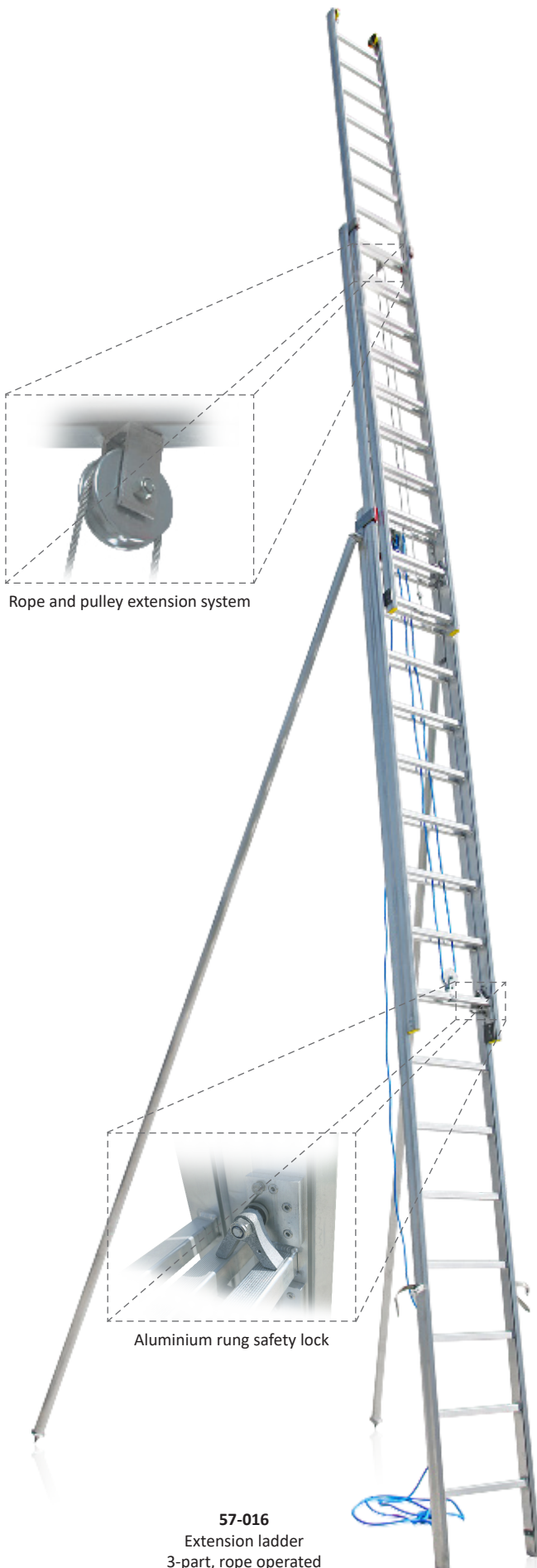

Rope and pulley extension system

Aluminium rung safety lock

57-016
Extension ladder
3-part, rope operated

Model No.	Length		Weight appox.	Stabiliser bar size
	Closed	Extended		
57-010	3,27 m	7,2 m	27 kg	1,2 m
57-012	3,83 m	8,88 m	32 kg	1,2 m
57-014	4,41 m	10,56 m	36 kg	1,2 m
57-016 ^	4,97 m	12,24 m	41 kg	-
57-018 ^	5,52 m	13,92 m	48 kg	-
57-020 ^	6,08 m	15,07 m	56 kg	-
57-022 ^*	6,64 m	16,23 m	60 kg	-
57-024 ^*	7,2 m	17,91 m	64 kg	-

*Only available by order

Note:

In order to comply with safety standards, additional safety Stabilisers are required for models marked with ^. The appropriate Stabiliser for each of these ladders can be found in the table below.

Stabilisers

for type 57

Model No.	Suitable for ladder Model No.	Weight appox.
57-001	57-016	3,5 kg
57-002	57-018	3,9 kg
57-003	57-020	3,9 kg
57-004	57-022	4,5 kg
57-005	57-024	4,8 kg

Industrial step ladders

Type 52

Aluminium step ladder

- tested and manufactured according to ÖNORM EN 131 and ÖNORM Z 1501 standards
- universal ladder for professional and everyday use
- built with strong and secure aluminium joints
- distance between rungs is 30 cm
- distance between the top round, non-mountable rungs is 32 cm, which allows for comfortable standing
- includes tear-resistant nylon opening restraints. Option for galvanized chain upon request (ideal for welding work)

Model No.	Length	Weight approx.
52-004	1,37 m	5 kg
52-005	1,67 m	6 kg
52-006	1,97 m	7 kg
52-007	2,27 m	8 kg
52-008	2,57 m	9,5 kg
52-009	2,87 m	11,5 kg
52-010	3,17 m	14 kg
52-011	3,47 m	16 kg
52-012	3,77 m	17 kg
52-013	4,07 m	19 kg
52-014	4,37 m	20 kg
52-016	4,97 m	25 kg
52-018	5,57 m	28 kg
52-020	6,17 m	35 kg



52-006
Step ladder

19-520
Ladder leveler

Ladder levelers

- allows for ladder use on stairs or uneven ground
- uses dual clamps for easy attachment without the use of tools

Model No.	Size	Suitable for ladder Model No.
19-520	60 mm	52-009 až 52-018, stejně jako R-300
19-521	50 mm	
19-522	70 mm	

Type 55

Aluminium step ladder

- extendable on both sides
- perfect for use on stairs
- stabiliser bars located on both sides for maximum stability
- includes plastic anti-slip safety feet to ensure firm positioning during use
- uses a continuous patent joint system
- built with plastic-coated metal rung hooks
- includes tear-resistant nylon opening restraints
- distance between rungs is 28 cm

Model No.	Length		Weight approx.	Stabiliser bar size
	Closed	Extended		
55-006	1,97 m	3,12 m	18 kg	0,8 m
55-008	2,53 m	4,24 m	23 kg	0,8 m
55-010	3,09 m	5,36 m	27 kg	1 m
55-012	3,65 m	6,17 m	33 kg	1 m



55-006
Step ladder - extended

Industrial folding ladders

Type 75-000

Aluminium folding ladders

- tested and manufactured according to ÖNORM EN 131 standards
- uses minimal space during transportation and storage
- built with galvanized steel latching joints (see image)
- anti-slip rungs allow for safe and comfortable standing
- includes plastic anti-slip safety feet and top end-caps to ensure firm positioning during use
- stabiliser bars located on both ends of the ladder for maximum stability

Model No.	Number of rungs	Weight approx.	Stabiliser bar size
75-012	4 x 3	12,5 kg	0,95 m
75-016	4 x 4	14 kg	0,95 m
75-020	4 x 5	15,5 kg	0,95 m

Versatile positios:

Model No.	Lenght				Folded dimensions
	A	B	C	D	
75-012 ○	1,03 m	1,87 m	2,74 m	3,64 m	1,03 x 0,95 x 0,3 m
75-016	1,31 m	2,43 m	3,58 m	4,76 m	1,31 x 0,95 x 0,3 m
75-020	1,59 m	2,99 m	4,42 m	5,88 m	1,59 x 0,95 x 0,3 m

○ ...This product is suitable for work platform (see illustration). The platform dimensions are: with a length of 1.56 m and a height of 0.99 m. The base plate is available on request.

Ladder additions

for type 75-000

We offer both foldable and rigid additions that are suitable for a variety of needs.

- built with two sets of plastic coated steel rung hooks with a lifting lock system

Model No.	Lenght		Weight approx.
	Folded	Expanded	
75-006	-	2 m	5 kg
75-106	1 m	2 m	6 kg



75-016
Leaning ladder
position

75-016
Free standing
ladder position

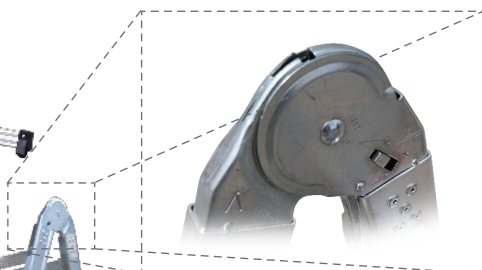

Galvanized latching joints

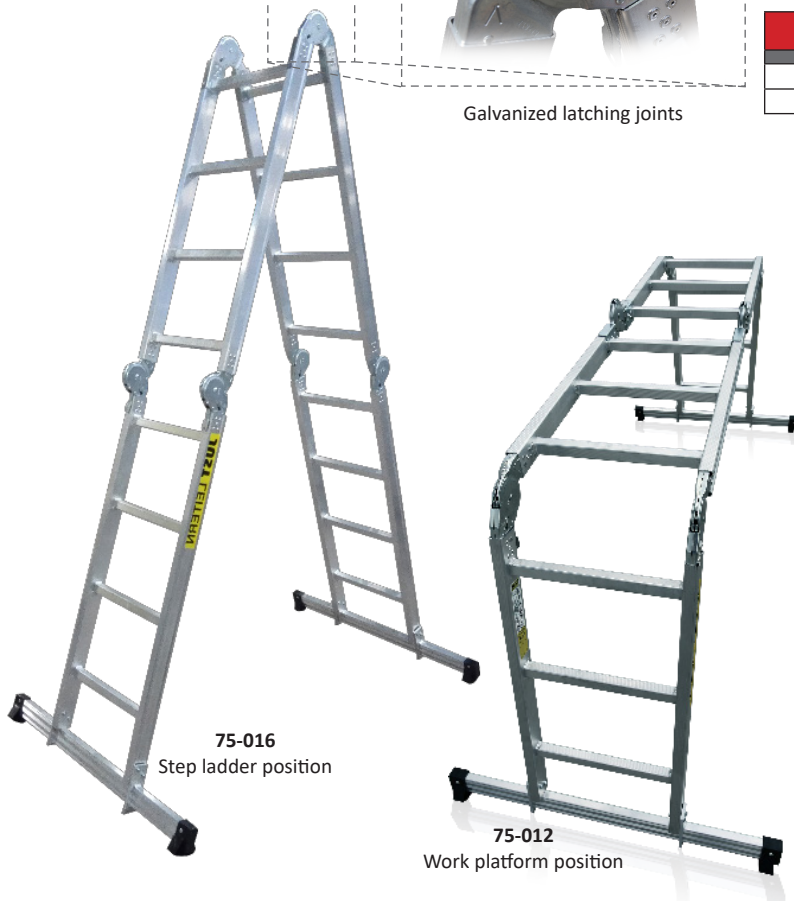

75-016
Step ladder position

75-012
Work platform position



75-106
Foldable ladder addition



75-016
Compact for transportation
and storage

Industrial telescopic ladders

Type 75-200F

Aluminium telescopic ladder with stabiliser bars

- tested and manufactured according to ÖNORM EN 131 standards
- foldable and extendable for various applications
- perfect for work spaces with large changes in level such as staircases

Model No.	Number of rungs	Weight approx.	Stabiliser bar size
75-212F	4 x 3	11kg	0,7 m
75-216F	4 x 4	14 kg	0,8 m
75-220F	4 x 5	17 kg	0,9 m
75-224F	4 x 6	20 kg	1 m

Model No.	Min - max length		Dimensions
	Leaning ladder	Step ladder	
75-012F	1,96 - 3,1 m	0,98 - 1,5 m	1,03 x 0,5 x 0,2 m
75-016F	2,5 - 4,2 m	1,23 - 2,03 m	1,3 x 0,5 x 0,2 m
75-020F	3,07 - 5,3 m	1,49 - 2,57 m	1,58 x 0,5 x 0,2 m
75-224F	3,64 - 6,4 m	1,78 - 3,14 m	1,86 x 0,5 x 0,2 m

Telescopic platform

- can be used as scaffolding frame when combined with standing beam accessory
- extendable in a variety of positions
- use only in combination with Model 75-200F or with a Stabiliser bar

Model No.	Min - max length	Width	Height	Weight approx.
75-202 *	1,77 - 3 m	279 mm	60 mm	12,5 kg
75-203 *	2,27 - 4 m	279 mm	60 mm	16,5 kg

*Only available by order



75-216
Step ladder position

75-216
Leaning ladder position



75-202
Telescopic ladder
standing beam

75-212 with stabiliser bar
Use as a small frame to support
a telescopic platform

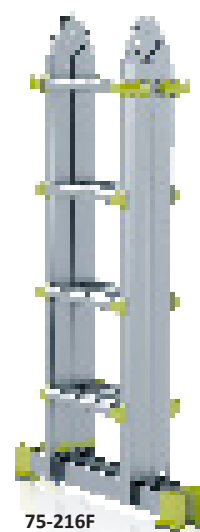

75-216F
Compact for transportation
and storage



75-216F
Suitable for use on stairs

Industrial telescopic ladders

Type 75-200

Aluminium telescopic ladders

- easily foldable and extendable
- perfect for work spaces with large changes in level such as staircases
- functions as a height-adjustable step ladder and leaning ladder
- can be disassembled to be used as two smaller step ladders

Model No.	Number of rungs	Weight approx.
75-212	4 x 3	11 kg
75-216	4 x 4	13 kg
75-220	4 x 5	16 kg
75-224	4 x 6	19 kg

Model No.	Min - max length		Dimensions
	Leaning ladder	Step ladder	Folded ladder
75-212	1,93 - 3,1 m	0,96 - 1,5 m	1,02 x 0,52 x 0,21 m
75-216	2,5 - 4,2 m	1,25 - 2 m	1,3 x 0,57 x 0,21 m
75-220	3,1 - 5,3 m	1,5 - 2,55 m	1,58 x 0,63 x 0,21 m
75-224	3,6 - 6,4 m	1,8 - 3,1 m	1,89 x 0,71 x 0,21 m

Stabiliser bar

- suitable for ladder Model 75-200
- recommended when using ladder as a scaffolding base

Model No.	Weight approx.
75-205 *	1 kg

*Only available by order

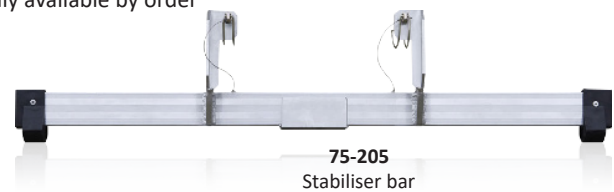

Ladder leveler

- allows for ladder use on stairs or uneven ground
- adjustable to suit various work environments

Model No.	Weight approx.
75-204 *	1 kg

*Only available by order

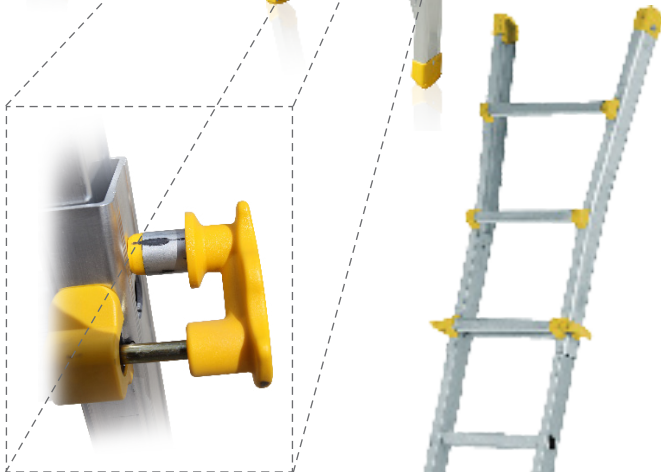

Plastic-coated steel bolt link

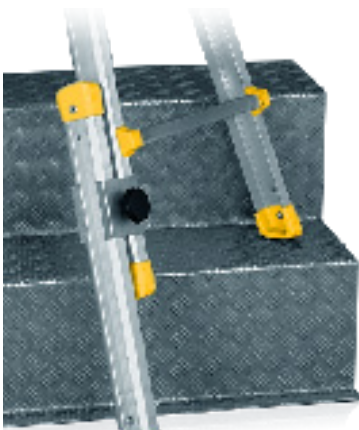

Industrial telescopic ladders

www.cervinkafire.com
www.hasicipristroje-cervinka.com

TELESTEPS Aluminium telescopic ladders

- compact and lightweight for easy storage and transportation, while also being safe and stable to climb
- made of high quality anodized aluminum with fibreglass reinforced plastic fittings
- wide treads for comfortable standing, even over long periods of time
- simple and safe unlocking
- rubber anti-slip safety feet are built at a 75° angle for maximum floor grip and stability

Type 75-320

TELESTEPS - leaning ladder

- innovative triangular design for increased stability and strength
- correct leaning angle
- rung width of 50mm

Model No.	Rungs count	Length		Width	Weight approx.
		Folded	Extended		
75-321	10	0,81 m	3 m	0,47 m	10,5 kg

Type 75-320F

TELESTEPS - leaning ladder with stabiliser bar

- tested and manufactured according to ÖNORM EN 131
- similar to Model 75-323 but built with a Stabiliser bar

Model No.	Rungs count	Length		Width	Weight approx.
		Folded	Extended		
75-320F *	11	0,88 m	3,5 m	0,48 m	14,5 kg
75-323F *	13	0,93 m	4,1 m	0,49 m	16,5 kg

*Only available by order

Type 75-320

TELESTEPS – multifunkční žebřík

- three ladders in one; can be used as a step ladder, free-standing ladder and leaning ladder
- tested and manufactured according to ÖNORM EN 131
- minimal turning radius in small spaces
- tread width of 90mm

Model No.	Rungs count	Length		Width	Weight approx.
		Folded	Extended		
75-326	6 + 2	0,71 m	2,3 m	0,69 m	14,4 kg
75-328 *	8 + 2	0,78 m	3 m	0,77 m	19,5 kg

*Only available by order

Accessories for telesteps ladders

Model No.	Details
EK1921	Rubber anti-slip feet for ladder 75-320
EK1924	Rubber anti-slip feet for ladder 75-323
EK1922	Rubber anti-slip feet for 75-326 and 75-328
EK1923	Tool tray for ladders 75-326 and 75-328

75-321
TELESTEPS
Leaning ladder, extended



75-321
TELESTEPS
Leaning ladder folded



75-326
TELESTEPS
Combination ladder, free-standing position



75-326
TELESTEPS
Combination ladder, folded



EK1923
Convenient tool tray

72-005
Aluminium platform step ladder



Type 72 Platform ladder with treads

- tested and manufactured according to ÖNORM EN 131 standards
- ideal ladder for household uses
- extremely lightweight
- models 72-006 to 72-008 come with a chain or nylon opening restraint
- tread width of 80mm

Model No.	Length	Platform height	Weight approx.
72-003	1,3 m	0,67 m	3,4 kg
72-004	1,5 m	0,9 m	3,9 kg
72-005	1,7 m	1,11 m	4,5 kg
72-006	2 m	1,35 m	5,7 kg
72-007	2,1 m	1,56 m	6,5 kg
72-008	2,4 m	1,78 m	7,2 kg

Type 73 Platform ladder with treads

- tested and manufactured according to ÖNORM EN 131
- access from one side of the A-frame
- high guard beam provides a secure working space
- large standing platform locks the ladder into working position, ensuring both long-standing comfort and safety (see image)
- models 73-006 to 73-012 are built with additional tear resistant spreading restraints
- tread width of 85 mm

Model No.	Length	Platform height	Weight approx.
73-003	1,44 m	0,69 m	5 kg
73-004	1,68 m	0,95 m	6 kg
73-005	1,94 m	1,16 m	7 kg
73-006	2,19 m	1,39 m	8 kg
73-007	2,4 m	1,6 m	9 kg
73-008	2,69 m	1,87 m	10 kg
73-009	2,94 m	2,21 m	12 kg
73-010	3,19 m	2,36 m	12,5 kg
73-012	3,69 m	2,82 m	15 kg

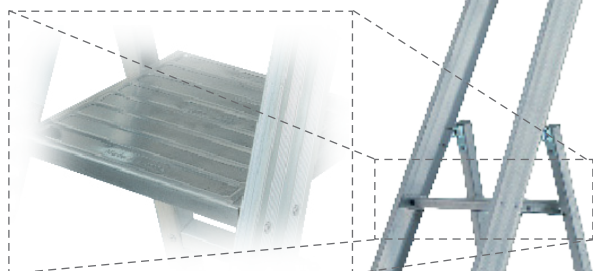

Large standing platform

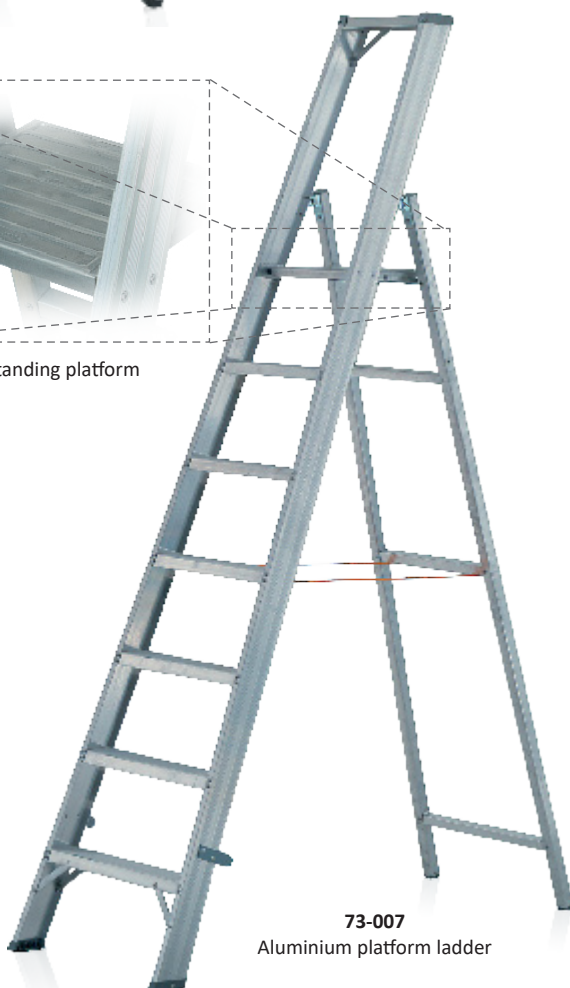

73-007
Aluminium platform ladder

Flat-rung ladders

Aluminium flat-rung ladders

- user-friendly, with 6,4 cm wide ribbed flat-rungs
- includes plastic anti-slip safety feet and top end-caps to ensure firm positioning during use
- load capacity of up to 150kg
- available with any RAL colour coating or as natural anodized aluminium

Type 59-100

Aluminium leaning ladder with flat-rungs

- tested and manufactured according to ÖNORM EN 131 standards
- rungs welded to provide a comfortable climb at a 70° ladder pitch
- built with anti-slip plastic end-caps on the top end of the beams
- total ladder width of approx. 40cm
- models 59-112 to 59-115 are built with Stabiliser bars

Model No.	Length	Weight approx.	Stabiliser bar size
59-106	2 m	4,3 kg	-
59-108	2,5 m	5,5 kg	-
59-110	3 m	6,6 kg	-
59-112	3,5 m	7,8 kg	0,8 m
59-113	4 m	8,8 kg	0,8 m
59-115	4,5 m	9,9 kg	1 m
59-117	5 m	11 kg	1 m

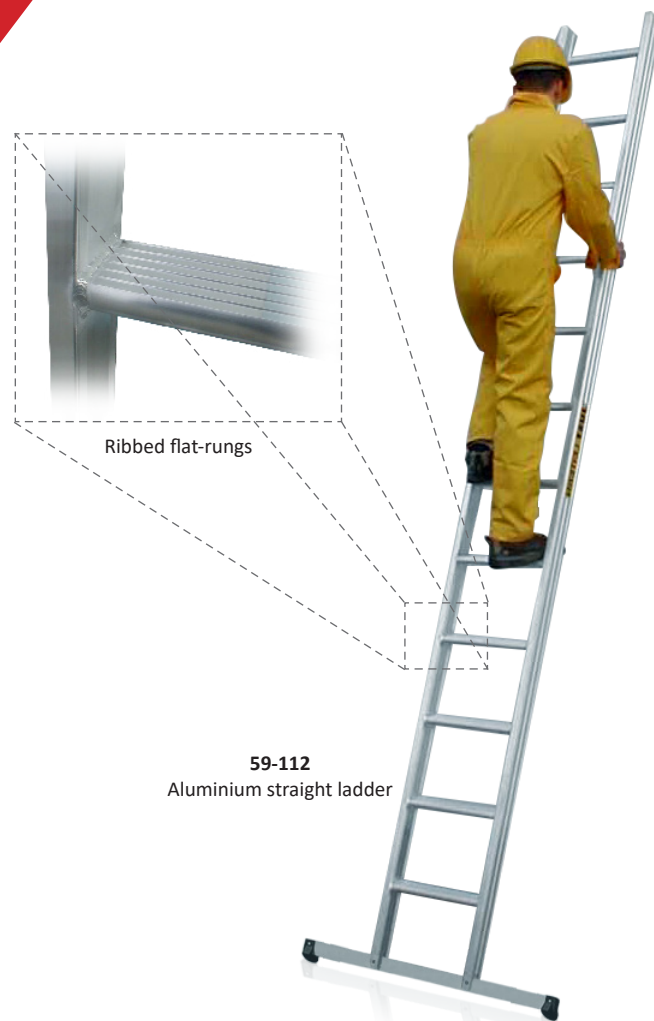

Type 58-100

STEP - Aluminium step ladder with flat-rungs

- tested and manufactured according to ÖNORM EN 131 standards
- built with specially designed rungs that are welded to the beams with a continuous patented joint (see image).
- includes tear-resistant nylon opening restraints
- accessible from both sides of the A-frame

Model No.	Length	Weight approx.
58-103	0,77 m	3,2 kg
58-104	1,02 m	4,2 kg
58-105	1,27 m	5,2 kg
58-106	1,52 m	6,95 kg
58-107	1,77 m	8,2 kg
58-108	2,02 m	9,4 kg



Type 58-200

Aluminium folding steps

- tested and manufactured according to DIN 14183 standards
- platform size of approx. 600 x 300 mm
- tread width of approx. 85 mm
- locking spreader keeps the ladder sturdy and prevents folding while in use

Model No.	Number of steps	Height approx.	Weight approx.
58-202	2	440 mm	5,2 kg
58-203	3	650 mm	7 kg
58-204	4	860 mm	9 kg



59-012
Stair leaning ladder

58-006
Stair step ladder

Aluminium stair ladder

- built with sturdy U-rungs
- each tread is 8.5 cm wide and corrugated for anti-slip foot grip
- includes plastic anti-slip safety feet to ensure firm positioning during use
- bracing under every fifth step for additional reinforcement (see image)
- load capacity of up to 150 kg

Type 59

Stair leaning ladder

with treads

- tested and manufactured according to ÖNORM EN 131
- total ladder width of 39.5 cm
- models 59-013 and 59-014 are built with a Stabiliser bar

Model No.	Length	Weight approx.	Stabiliser bar size
59-008	2 m	5 kg	-
59-009	2,25 m	6 kg	-
59-010	2,5 m	6,5 kg	-
59-011	2,75 m	7 kg	-
59-012	3 m	7,5 kg	-
59-013	3,25 m	8 kg	0,8 m
59-014	3,5 m	8,5 kg	0,8 m

Type 58

Stair step ladder

with treads

- tested and manufactured according to ÖNORM EN 131
- accessible from both sides of the A-frame
- built with additional tear resistant spreading restraints

Model No.	Length	Weight approx.
58-002	0,5 m	4 kg
58-003	0,75 m	5 kg
58-004	1 m	6 kg
58-005	1,25 m	7 kg
58-006	1,5 m	8 kg
58-008	2 m	11 kg
58-010	2,5 m	14 kg
58-012	3 m	17 kg

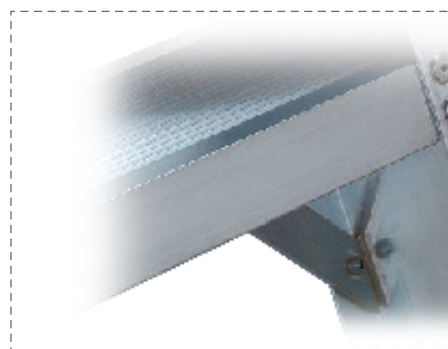

Step brace reinforcement

Sawhorses

Type 13

Folding wooden sawhorse

Designed to be a lightweight and sturdy work surface and support tool.

- work surface size of 55 x 45 mm
- support rungs have a diameter of 28mm and are rounded for more stability while in use
- maximum load capacity of 300 kg



13-001
Folding wooden sawhorse

Type 45

Folding aluminium sawhorse

- made entirely of aluminium
- built with strong reinforcement bars and beams that are CMT welded for longevity
- foldable for easy transportation and storage
- maximum load capacity of 300 kg

Model No.	Height	Bar width	Weight approx.
45-601	88,5 cm	90 cm	6,6 kg

Type 45

Stohovatelná hliníková podpěra

- silná a pevná pozice
- skládací: snadná přeprava
- maximální zatížení 150 kg

Model No.	Height	Bar width	Weight approx.
45-603	88,5 cm	90 cm	3,5 kg



45-601
Foldable aluminium sawhorse



45-603
Stackable sawhorses



19-005
Ladder hook



19-008
Reversed ladder hook

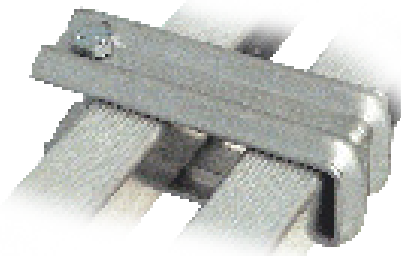

19-104
Rung lock



19-012
Wall mounting pipe with angle brackets

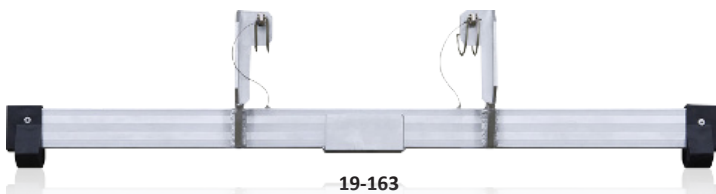

19-163
Standard stabiliser bar for retrofitting



19-042
Wall bracket steel



19-043
Wall bracket steel, lockable



19-040
Wall bracket aluminium



19-043
Wall bracket aluminium, lockable

Ladder hooks

- suitable for any ladder to easily hang on
- hooks works in conjunction with the wall mounting pipe (19-012) or with the rollable hanging ladder system (80-102: please visit our website for more details on this product)
- when using hooks with sliding ladders, must be used in conjunction with rung lock (19-104)

Model No.	Suitable for
19-005	Pipe diameter 25 mm
19-006	Pipe diameter 50 mm

Does not come pre-mounted.

Reversed ladder hook

- serves the same application as model 19-005
- mountable on the outer sides of the ladder beams

Model No.	Suitable for
19-008	Pipe diameter 25 mm

Does not come pre-mounted.

Rung lock

- used as additional security for extension and combination ladders
- mandatory for extension ladders and when using ladder hook models 19-005, 19-006 and 19-008

Model No.	Details
19-104	Rung lock

Wall mounting pipe

- made from aluminium
- easily mountable on the wall (comes with angle brackets)
- used to hang ladders when in combination with either ladder hook model 19-005 or reverse ladder hook model 19-008

Model No.	Details
19-012	Pipe diameter 25 mm

Stabiliser bar

- stabiliser bars are already included with all combination ladders
- must be purchased separately for all other ladders

Model No.	Details
19-163	Standard Stabiliser bar for retrofitting
19-164	Stabiliser bar for additional support

Does not come pre-mounted.

Wall brackets

- for easy storage of ladders on the wall

Model No.	Details
19-040	Aluminium; adjustable up to 130 mm
19-041	Aluminium; lockable*; adjustable up to 130 mm
19-042	Steel; 200 mm
19-043	Steel; lockable* 200 mm

*Product does not include lock

Ladder platform

- an aluminium standing platform that can be hooked onto any standing rung of any aluminium ladder with a rung spacing of 28 cm
- provides comfortable standing for long periods of time

Model No.	Details
19-550	ladder platform



19-550
Ladder platform

Wall-running wheels

- allows for smooth and easy ladder extension
- suitable for all extension and combination ladders
- wheel diameter of 100 mm

Model No.	Details
19-147	Wall-running wheel



19-147
Wall-running wheel

Spare joints

- product comes with complete repair kit and screws for both sides of the ladder
- two joints required for each ladder

Model No.	Suitable for ladder models
19-050	52-004 to 52-008
19-051	52-009 to 52-018
19-052	52-020

Wheels and bracing

- allows the ladder to be moved while in an unfolded position (without load)
- suitable for all step ladders

Model No.	Details
19-010	Wheels and bracing

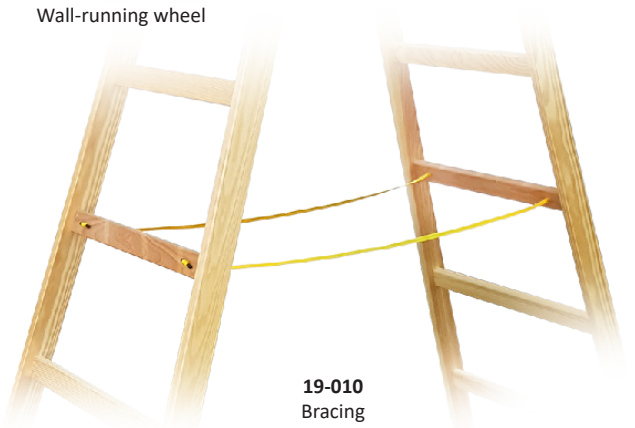

19-010
Bracing

Ladder caster

- caster attaches to bottom of the ladder's beams
- does not come included with wheels, therefore must be used in conjunction with 19-010
- compression spring allows load to transfer from the wheels to the plastic feet when climbing

Model No.	Details
EK1113	Ladder Caster



19-010
Wheels for smooth travel



EK-1113
Retractable wheel

Shaft ladders

- available in aluminum, ionodized aluminum, galvanized steel or stainless steel
- diverse selection of standard and additional parts

Shaft ladders - standard

- wide range of mounting brackets and additional articles

Model No.	Suitable for ladder models	Length
60-008	Shaft ladder - standard	6 m
60-009	Shaft ladder extended on request	

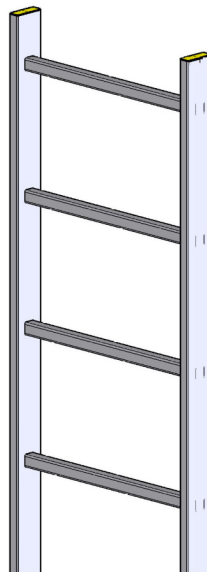

60-008
Shaft ladder - standard

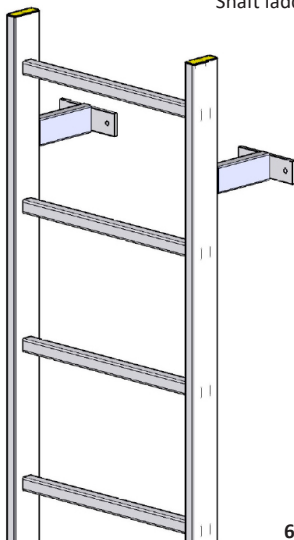

60-401
Robust shaft ladders

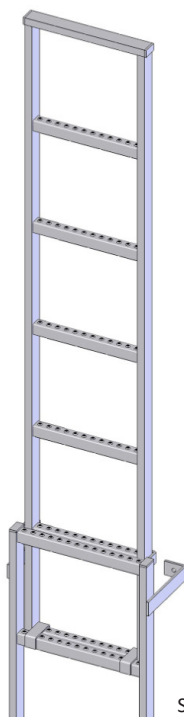

60-300
Shaft ladders - Stainless steel

Shaft ladders with a massive structure

- in cooperation with security technology company has developed various aluminum ladders with fixed welded stabilizers.
- entry helpers and other additional parts offer maximum security.

Shaft ladders - Stainless steel

- used in connection with aggressive substances, and everywhere, where aluminum cannot be used.
- material V2A or V4A

Stationary ladders

www.cervinkafire.com
www.hasicipristroje-cervinka.com

Vertical ladders

- made of aluminum, stainless or galvanized steel
- made according to your specifications and authority requirements
- various access control gadgets, switch landings and exits



Protective systems

Naturally, the company JUST LEITERN AG also offers climbing protective systems in:

- aluminium, galvanized steel and stainless steel, with personalized security for the climber

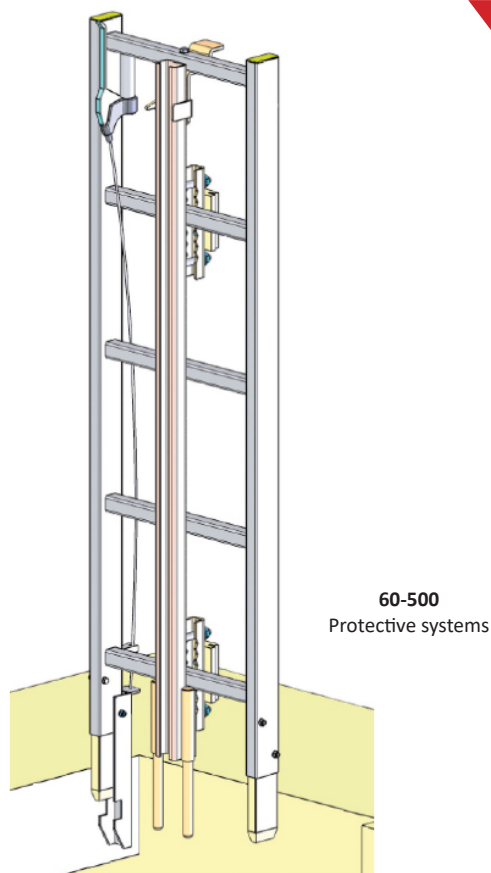

Aluminium ladders for fix installation on the roof or hanging on the ridge.

- these ladders are suitable for lifting on the roof with a slope of 74 degrees
- rungs and bars are made of high-aluminum structures which are resistant to atmospheric conditions
- depending on the type of roof, we have developed especially designed hooks to ensure the greatest reliability
- the ladders can also be supplied as models with a polymer coating (color depending on the buyer's request) with an additional surcharge.

Model No.	Suitable for
60-201	Ladder for the roof aluminium 3 m
60-202	Ladder for the roof aluminium 6 m
60-203	Connecting lining to nipple up the ladder pieces
60-204	Hooks for mounting on the roof (standard)
60-205	Hooks, stainless steel, universal
19-013	Hooks to attach the ladder to the roof (hang on gable)
49-910	Hooks for the edge of the roof, depending on slope

Special ladders

Window cleaning ladders

Available as an:

- extension ladder
- sectional ladder
- 1-part ladder

Rungs are welded to the beams. Conical convergent with a soft top layer to protect the window pane.

Poster ladders

Welded extension ladder with rungs.

- peeks at the feet
- small, light and handy

Window cleaning ladder



Poster ladder



Agricultural Ladders

Ladders for the agricultural sector e.g. in the fruit harvest.

Type 50-000R

Agricultural Leaning Ladder

Above pointedly converging for easy leaning against trees. Tops on the underside for a secure hold, even when the ground is loose.

Type 59-300

Agricultural Ladder - "Staffelei"

- low weight with highest safety
- bonically converging ladder
- at the tips the parts converge

Model No.	Model	Length
59-320	Agricultural ladder "Staffelei"	2 m
59-325	Agricultural ladder "Staffelei"	2,5 m

Tips for Agricultural Ladder - "Staffelei"

- for increased stability

Model No.	Model
59-353	Tips for Agricultural Ladder "Staffelei" (2 pcs)

Type 59-200

Agricultural ladder - Industry

- upwards converging ladder
- specially developed, in flat rungs integrated joint
- supportive adjustable aluminium tube
- non-slippery flat bars; 6,4 cm wide, round welded
- welded tips on all three legs for increased stability

Model No.	Model	Number of rungs	Length
59-220	Agricultural ladder - Industry	6	2 m
59-225	Agricultural ladder - Industry	8	2,5 m
59-230	Agricultural ladder - Industry	10	3 m



50-000R
Agricultural Leaning Ladder



59-325
Agricultural ladder "Staffelei"



59-200
Agricultural ladder - Industry



59-353
Tips for Agricultural Ladder - "Staffelei"

Special ladders

Rope ladders

Kletterfix

The smallest safety ladder in the world.

The fastest way to safety is the shortest and in the worst case the only way. Those who do not want to risk that the emergency services come to late can escape through the window or from the balcony with KLETTERR-FIX. Packaged as small as a book in use as big as a high-rise!

Model No.	Length in levels	Length	Weight	Package size
61-001	2	5 m	2 kg	300 x 180 x 30 mm
61-002	3	8 m	3 kg	300 x 280 x 30 mm
61-005	4	12 m	4,5 kg	300 x 200 x 70 mm
61-006	5 - 6	16 m	6,5 kg	300 x 280 x 70 mm
61-007	7 - 8	22 m	9 kg	300 x 360 x 70 mm

Model No.	Model	Weight	Package size
61-008	Wall anchor	0,25 kg	250 x 60 x 35 mm
61-009	Distance roller	0,25 kg	300 x 70 x 70 mm



61-005
Kletterfix - compact



Maintenance ladders

Type 62

Free-standing aluminum ladders with moving part up to 11 m high

Everywhere where a ladder cannot be leaned against something, the maintenance ladder is the right solution. The ladder is free standing and is suited perfectly for electric installation, to change hanging lights like streetlights, to clean large glass areas and for a large number of other uses.

The height adjustment can be achieved from rung to rung with automatic patent hooks. The ladder is made completely from special high-profile aluminum and is protectively welded.



Movable ladders

Type 64

Free-standing aluminum ladder up to 24 m high

Expansion lengths 9 to 24 m are available as standard (higher - on request).

- the parts of the ladder (from 9 to 11 m - two sections, from 15 to 18 m - three section and from 21 m - four section) work maintenance free
- army welder safety gallery, wide steps and a safety ring make it possible to work without holding on
- in addition, there is a lot of additional equipment



Special ladders

Type 66

For installation on standard-type trucks

- with a flatbed truck platform
- revolving steel rack with a pulley support turning device
- mounted on bearings
- lifting kit made from special high aluminum profiles and ball bearing mechanisms

Mobile and hanging ladder systems

- step ladders made of aluminium with rolling head and running on rail
- for safe management of shelves

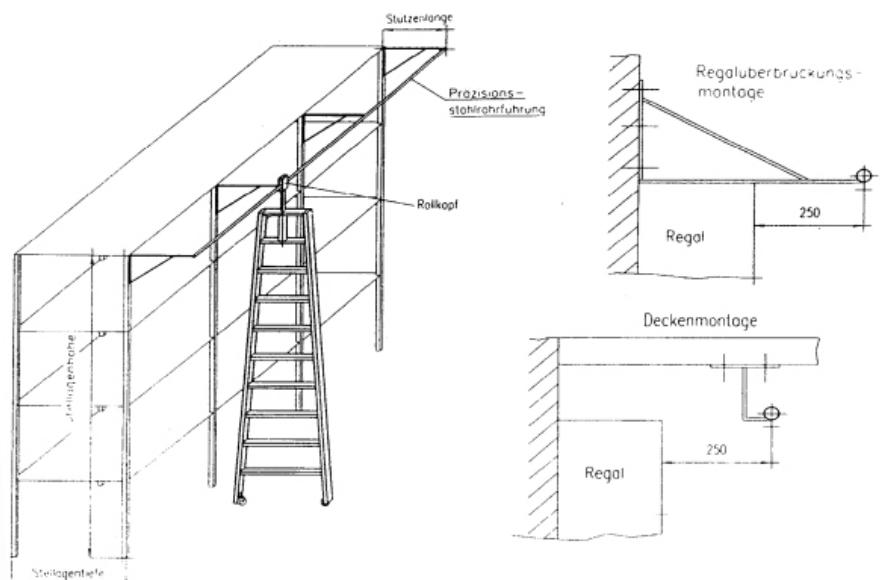



ČERVINKA s.r.o.
NAŠE SLUŽBY – VAŠE BEZPEČNOST

ČERVINKA 
CZECH REPUBLIC S.R.O.



Official distributor for Czech republic

130 years of experience





ČERVINKA s.r.o.
NAŠE SLUŽBY – VAŠE BEZPEČNOST

ČERVINKA
CZECH REPUBLIC S.R.O.



Official distributor for Czech republic

130 years of experience



Podolská 103/126
Praha 4, 147 00

Establishment:
Rostislavova 1265,
Uherské Hradiště, 686 01

ČERVINKA s.r.o.
+420 724 437 481
servis@hasicitechnika.com
www.hasicipristroje-cervinka.cz

ČERVINKA - CZECH REPUBLIC s.r.o.
+420 572 570 961
info@hasicitechnika.com
www.cervinkafire.com